

RATING	Kgf/cm ²	PSI
BODY	10.5 Kgf/cm ²	149 PSI
SEAT	7.7 Kgf/cm ²	110 PSI

RATING	Kgf/cm ²	PSI
BODY	10.5 Kgf/cm ²	149 PSI
SEAT	7.7 Kgf/cm ²	110 PSI

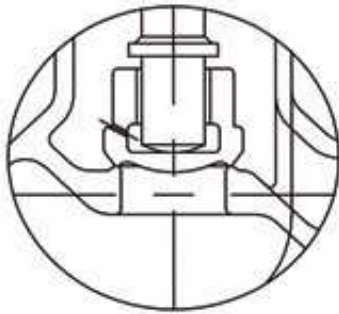

SDNR TYPE
 5K:F7351
 16K:F7409

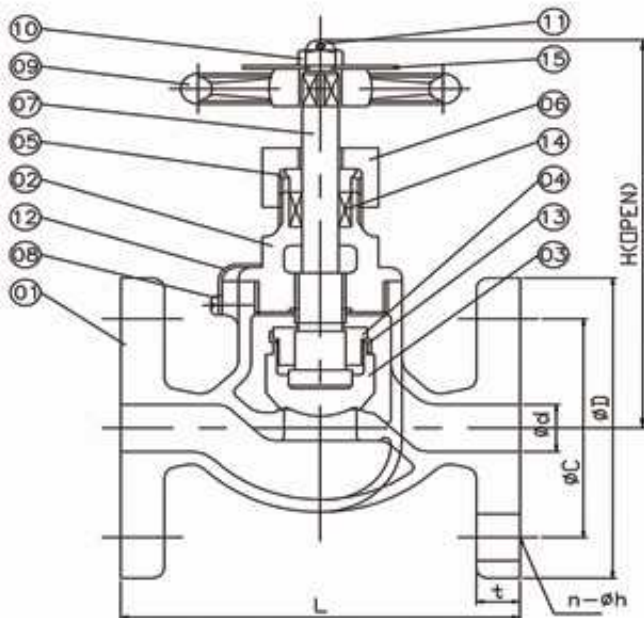

15	Name plate	JIS H 3100 - C 2801 P
14	Packing	JIS F 7102
13	Disk lock washer	JIS H 3100 - C 2600 P
12	Lock plate	JIS H 3100 - C 2600 P
11	Split pin	JIS H 3260 - C 2660 W
10	Hexagon nut	JIS H 3250 - C 3604 BD
09	Handwheel	JIS G 5501 - FC 20
08	Screw	JIS H 3260 - C 2700 W
07	Stem	JIS H 3250 - C 3771 BD or C 3771 BE
06	Gland nut	JIS H 5111 -BC 6 or JIS H 3250 - C 3771 BD or C 3604 BD
05	Packing gland	JIS H 3250 - C 3771 BD or C 3604 BD
04	Valve disc nut	
03	Disc	JIS H 5111 -BC 6 or JIS H 3250 - C 3771 BD or C 3771 BE
02	Bonnet	JIS H 3250 - C 3771 BD or C 3771 BE
01	Body	JIS H 5111 -BC 6

DIMENSION
(5K:F7301, 16K:F7303)

(Unit:mm)

SIZE	ød	L		5K FLANGE				16K FLANGE				H	WEIGHT (kg)	
		5K	16K	øD	øC	t	n-øh	øD	øC	t	n-øh		5K	16K
15A	15	100	110	80	60	9	4-12	95	70	12	4-15	130	2.02	2.76
20A	20	110	120	85	65	10	4-12	100	75	14	4-15	140	2.86	3.72
25A	25	120	130	95	75	10	4-12	125	90	14	4-19	160	3.54	5.20
32A	32	140	160	115	90	12	4-15	135	100	16	4-19	170	5.00	6.91
40A	40	160	180	120	95	12	4-15	140	105	16	4-19	190	6.48	8.43

CAST STEEL ANGLE VALVE 10K

RATING	Kgf/cm ²	MPa
BODY	21 Kgf/cm ²	2.1 MPa
SEAT	15.4 Kgf/cm ²	1.54 MPa

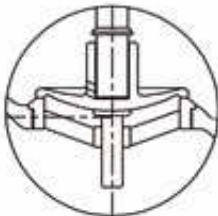
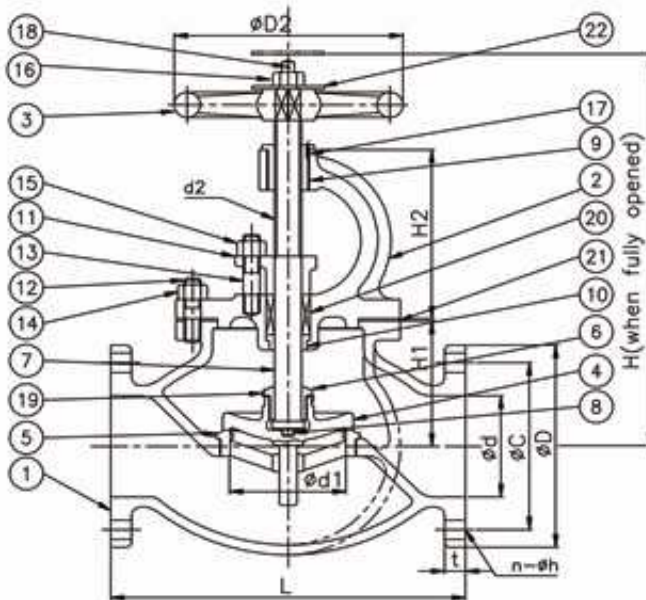
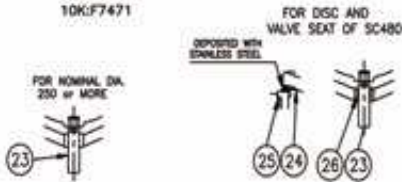

 SEAT TYPE
 10K:F7471

26	BUSH	JIS G 4303-SUS420J1
25	VALVE SEAT	
24	DISC	JIS G 5101-SC480
23	DISC GUIDE	JIS G 4303-SUS403
22	NAME PLATE	JIS H 3100-C2801P
21	GASKET	VALGUA 1500
20	PACKING	GRAPHITE
19	DISC LOCK WASHER	JIS G 4305-SUS304
18	SPLIT PIN	JIS H 3260-C2600W
17	LOCK PIN	JIS G 3101-SS400
16	HEXAGON NUT	JIS H 3250-C3771BD
15	HEXAGON NUT	
14	HEXAGON NUT	JIS G 3101-SS400
13	STUD	JIS G 3101-SS50
12	STUD	JIS G 4051-S35C
11	PACKING GLAND	JIS H 5111-BC 6
10	PACKING BUSH	JIS G 4303-SUS420J1
9	SCREWED BONNET BUSH	JIS H 3250-C6782BD
8	WASHER FOR STEM	JIS G 4404-SKD1
7	STEM	JIS G 4303-SUS403
6	DISC NUT	JIS G 4303-SUS420J1
5	VALVE SEAT	JIS G 5121-SCS2
4	DISC	
3	HAND WHEEL	JIS G 5501-FC200
2	BONNET	
1	BODY	JIS G 5101-SC480

DIMENSION

(Unit:mm)

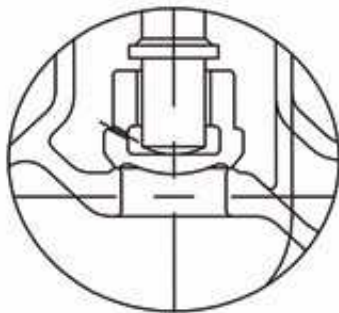
SIZE	ød	FLANGE JIS10K FF				L	H	H1	H2	ød1	ød2	øD2
		øD	øC	n-øh	t							
50A	50	155	120	4-19	16	220	270	90	120	58	TW22	160
65A	65	210	140	4-19	18	270	300	100	128	73	TW24	200
80A	80	185	150	8-19	18	300	310	105	128	88	TW24	200
100A	100	210	175	8-19	18	350	355	125	142	111	TW28	250
125A	125	250	210	8-23	20	420	415	150	165	138	TW32	280
150A	150	280	240	8-23	22	490	470	170	185	163	TW36	315
200A	200	330	290	12-23	22	570	565	210	218	213	TW42	355
250A	250	400	355	12-25	24	740	645	259	225	265	TW44	400
300A	300	445	400	16-25	24	840	735	300	249	315	TW48	450



SDNR TYPE

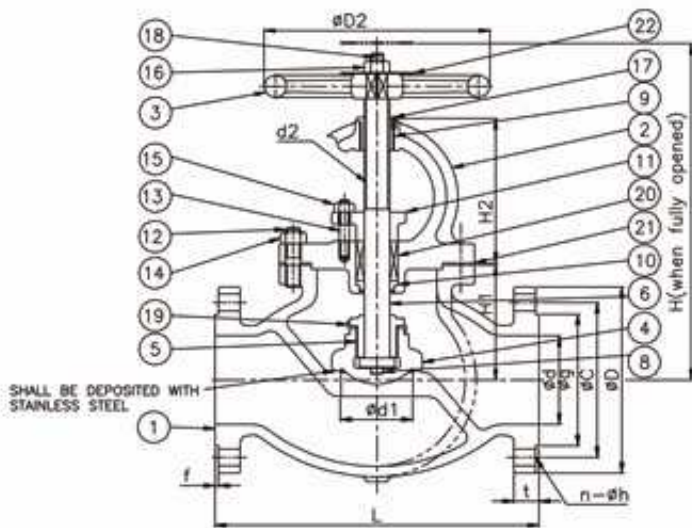

22	NAME PLATE	JIS H 3100-C2801P
21	GASKET	JIS F 7102
20	PACKING	
19	DISC LOCK WASHER	JIS G 4305-SUS304
18	SPLIT PIN	JIS H 3260-C2600W
17	LOCK PIN	JIS G 3101-SS400
16	HEXAGON NUT	JIS H 3250-C36048D
15	HEXAGON NUT	JIS G 3101-SS400
14	HEXAGON NUT	JIS G 4051-S25C
13	STUD	JIS G 3101-SS50
12	STUD	JIS G 4051-S35C
11	PACKING GLAND	JIS H 5111-BC 6
10	PACKING BUSH	JIS G 4303-SUS420J1
9	SCREWED BONNET BUSH	JIS H 3250-C67828D
8	WASHER FOR STEM	JIS G 4404-SKD1
6	STEM	JIS G 4303-SUS403
5	DISC NUT	JIS G 4303-SUS420J1
4	DISC	JIS G 4303-SUS 420J1orJ2 JIS G 5121-SCS 2
3	HANDWHEEL	JIS G 5501-FC200
2	BONNET	JIS G 5101-SC480
1	BODY	

DIMENSION

(Unit:mm)

SIZE	ϕd	FLANGE JIS20K RF						L	H	H1	H2	$\phi d1$	d2	$\phi D2$
		ϕD	ϕC	ϕg	f	t	n- ϕh							
32A	32	135	100	80	2	18	4-19	190	265	95	115	32	TW20	160
40A	40	140	105	85	2	18	4-19	200	280	100	122	40	TW22	160
50A	50	155	120	100	2	18	8-19	230	295	105	128	50	TW24	200
65A	65	175	140	120	2	20	8-19	270	330	125	138	65	TW26	224
80A	80	200	160	135	2	22	8-23	300	370	150	152	80	TW30	250
90A	90	210	170	145	2	24	8-23	320	395	140	160	90	TW32	280
100A	100	225	185	160	2	24	8-23	350	420	165	168	100	TW34	280
125A	125	275	225	195	2	26	8-25	430	475	185	192	125	TW38	315
150A	150	305	260	230	2	28	12-25	500	525	205	212	150	TW42	355
200A	200	350	305	275	2	30	12-25	560	605	225	240	200	TW50	450
250A	250	430	380	345	2	34	12-27	660	700	265	267	250	TW58	560

RATING	Kgf/cm ²	PSI
BODY	10.5 Kgf/cm ²	149 PSI
SEAT	7.7 Kgf/cm ²	110 PSI

RATING	Kgf/cm ²	PSI
BODY	10.5 Kgf/cm ²	149 PSI
SEAT	7.7 Kgf/cm ²	110 PSI

For nominal 32~80

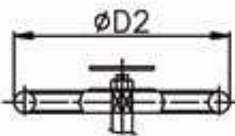

For nominal 32 and 40

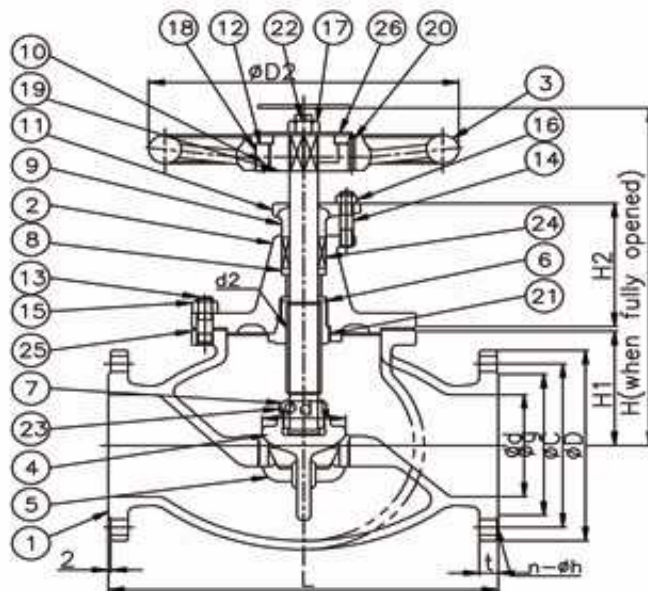
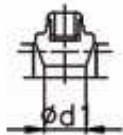

26	NAME PLATE	JIS H 3100-C 2801 P-H
25	GASKET	
24	PACKING	JIS F 7102
23	DISC LOCK WASHER	JIS H 3100-C 2600 P-0
22	SPLIT PIN	JIS H 3260-C 2600 W
21	STRAIGHT PIN	JIS H 3250-C 3771 BD
20	STRAIGHT PIN	JIS G 4051-S 35 C
19	POUNDING PIECE HOLDER	
18	POUNDING PIECE	JIS G 3104-SS 400
17	HEXAGON NUT	JIS H 3250-C 2771 BD
16	HEXAGON NUT	JIS G 3101-SS 400
15	HEXAGON NUT	JIS G 4051-S 25 C
14	STUD	JIS G 3101-SS 50
13	STUD	JIS G 4051-S 35 C
12	POUNDING RECEIVER PIECE	JIS G 3101-SS 400
11	PACKING GLAND	JIS G 4051-S 25 C
10	STEM	JIS G 4305-SUS 403
9	PACKING GLAND RING	
8	SEAT RING	JIS H 5111-BC 6
7	DISC NUT	
6	SCREWED BUSH	JIS H 5111-BC 6
5	VALVE SEAT	JIS G 5121 - SCS2
4	DISC	JIS G 5121 - SCS2
3	HAND WHEEL	JIS G 5501-FC 200
2	BONNET	
1	BODY	JIS G 5101-SC 480

DIMENSION

(Unit:mm)

SIZE	ød	FLANGE JIS30K RF					L	H	H1	H2	ød1	d2	øD2
		øD	t	øC	øg	n-øh							
32A	32	140	22	105	80	4-19	220	270	85	86	30	TW24	180
40A	40	160	22	120	90	4-23	240	280	85	90	40	TW24	180
50A	50	165	22	130	105	8-19	260	350	105	112	52	TW28	224
65A	65	200	26	160	130	8-23	310	390	120	127	72	TW32	250
80A	80	210	28	170	140	8-23	340	430	125	141	82	TW34	280
100A	100	240	32	195	160	8-25	390	480	140	162	102	TW38	315
125A	125	275	36	230	195	8-25	470	570	170	189	133	TW44	400
150A	150	325	38	275	235	12-27	540	655	200	220	162	TW50	450

RATING	Kgf/cm ²	PSI
BODY	10.5 Kgf/cm ²	149 PSI
SEAT	7.7 Kgf/cm ²	110 PSI

RATING	Kgf/cm ²	PSI
BODY	10.5 Kgf/cm ²	149 PSI
SEAT	7.7 Kgf/cm ²	110 PSI

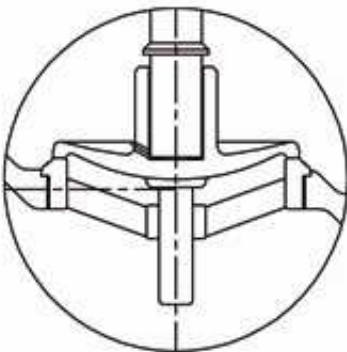
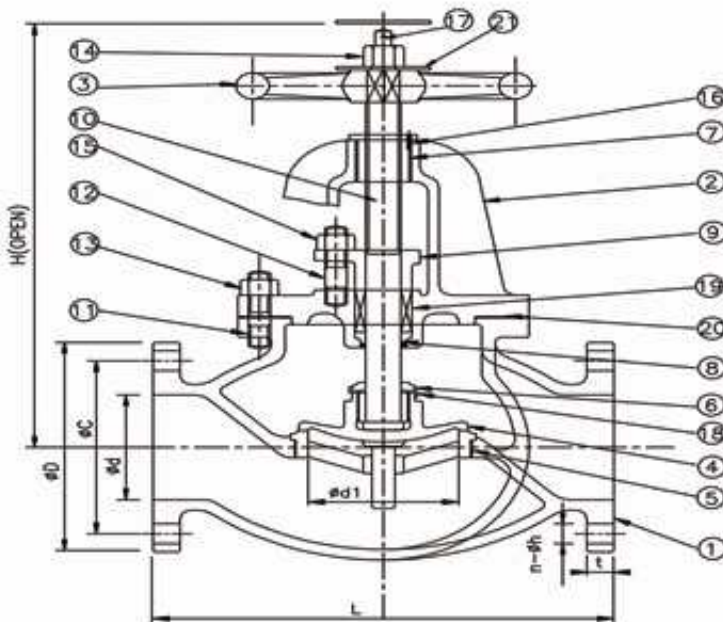

SDNR TYPE

21	NAME PLATE	BRASS
20	GASKET	
19	PACKING	JIS F 7102
18	DISC LOCK WASHER	BRASS
17	SPLIT PIN	BRASS
16	LOCK PIN	STEEL
15	HEXAGON NUT	BRASS
14	HEXAGON NUT	BRASS
13	HEXAGON NUT	STEEL
12	STUD	BRASS
11	STUD	STEEL
10	STEM	BRASS
9	PACKING GLAND	
8	SEAT RING	BRONZE
7	SCREWBONNET BUSH	
6	DISC NUT	BRASS
5	VALVE SEAT	BRONZE
4	DISC	BRONZE
3	HANDWHEEL	
2	BONNET	CAST IRON
1	BODY	

DIMENSION (5K:F7305, 10K:F7307)
(Unit:mm)

SIZE	ød	ød1	L		5K FLANGE				10K FLANGE				H		WEIGHT (kg)	
			5K	10K	øD	øC	t	n-øh	øD	øC	t	n-øh	5K	10K	5K	10K
50A	50	58	210	220	130	105	16	4-15	155	120	20	4-19	270	285	14.7	19.9
65A	65	73	250	270	155	130	18	4-15	175	140	22	4-19	300	310	21.3	28.7
80A	80	88	280	300	180	145	18	4-19	185	150	22	8-19	310	320	27.7	32.4
100A	100	111	340	350	200	165	20	8-19	210	175	24	8-19	360	370	40.8	48.7
125A	125	138	410	420	235	200	20	8-19	250	210	24	8-23	390	420	57.6	73.1
150A	150	163	480	490	265	230	22	8-19	280	240	26	8-23	445	470	80.3	104.0
200A	200	213	570	570	320	280	24	8-23	330	290	26	12-23	530	555	139.0	162.0

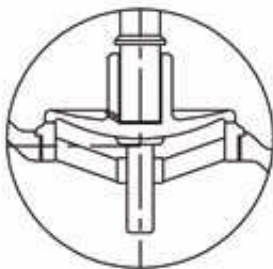
BODY	33 Kgf/cm ²
SEAT	24.2 Kgf/cm ²



SDNR TYPE

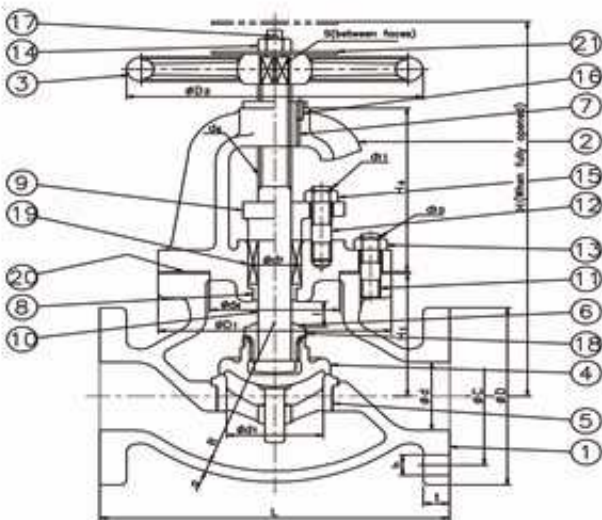

21	Name plate	JIS H 3100-C 2801 P
20	Gasket	JIS F 7102
19	Packing	NON-AESBEST
18	Disc lock washer	C 2600 P
17	Split pin	JIS H 3260-C 2600 W
16	Lock pin	JIS G 3101-SS 41
15	Hexagon nut	JIS H 3250-C 3604 BD
14	Hexagon nut	JIS H 3250-C 3604 BD
13	Hexagon nut	JIS G 3101-SS 41
12	Stud	JIS H 3250-C 3771BD
11	Stud	JIS G 3101-SS 41
10	Stem	JIS H 3250-C 3771 BD
9	Gland	JIS H 5111-BC 6
8	Seat ring	BC 6
7	Screwed bonnet bush	C 3771 BD
5	Valve seat	JIS H 5111-BC 6 or
4	Disc	JIS G 5121-SCS2
3	Handwheel	JIS G 5501-FC 20
2	Bonnet	JIS G 5501-FC 20
1	Body	JIS G 5501-FC 20

DIMENSION

(Unit:mm)

Nominal dia	Flange													Body						Stem		Threads		Reference Calculated mass(kg)	
	d	d ₁	L	D	Bolt hole			Nominal dia of bolt	t	Height H	Lift l	Handwheel D ₂	d ₂	a	R	H ₁	D ₁	d ₄	H ₄	Threads		d ₇	d ₁₀		d ₁₁
					P.C. dia. C	No.	h													d ₆	S				
50	50	58	220	155	120	8	19	M16	20	285	17	160	110	10	110	95	155	78	130	TW22	14	36	M16	M12	19.6
65	65	73	270	175	140	8	19	M16	22	310	22	200	135	11	135	105	175	95	135	TW24	17	38	M16	M12	28.3
80	80	88	300	200	160	8	23	M20	24	420	27	224	160	12	160	115	205	110	148	TW26	19	42	M20	M12	40.4
100	100	111	350	225	185	8	23	M20	26	385	33	250	195	13	195	135	230	135	160	TW30	22	48	M20	M12	56.9
125	125	138	420	270	225	8	25	M22	26	455	42	315	240	15	240	160	270	165	185	TW36	27	56	M22	M16	89.5
150	150	163	490	305	260	12	25	M22	28	510	50	355	280	16	280	185	295	190	205	TW42	30	66	M22	M16	123
200	200	213	570	350	305	12	25	M22	30	630	67	450	365	19	365	225	350	240	230	TW48	36	74	M22	M16	188